

J1- JANELA MAXIM-AR- 80x60

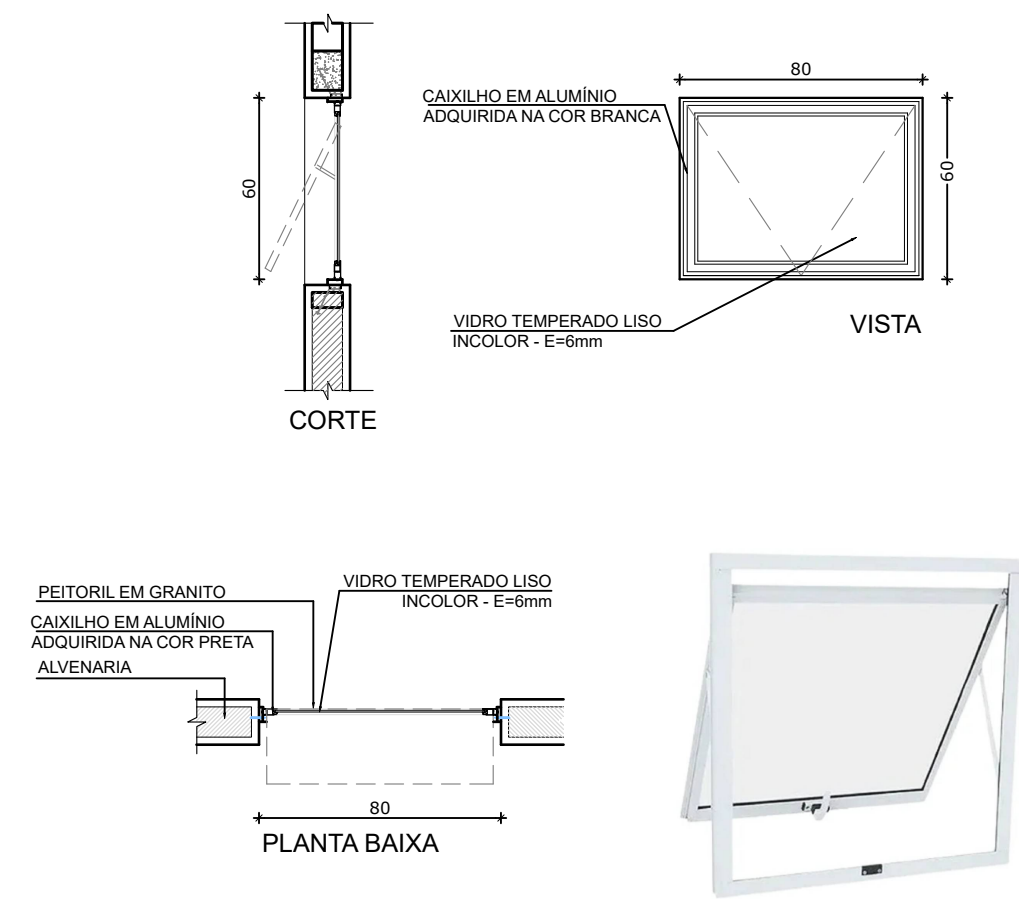

J2- JANELA DE CORRER - 140x100

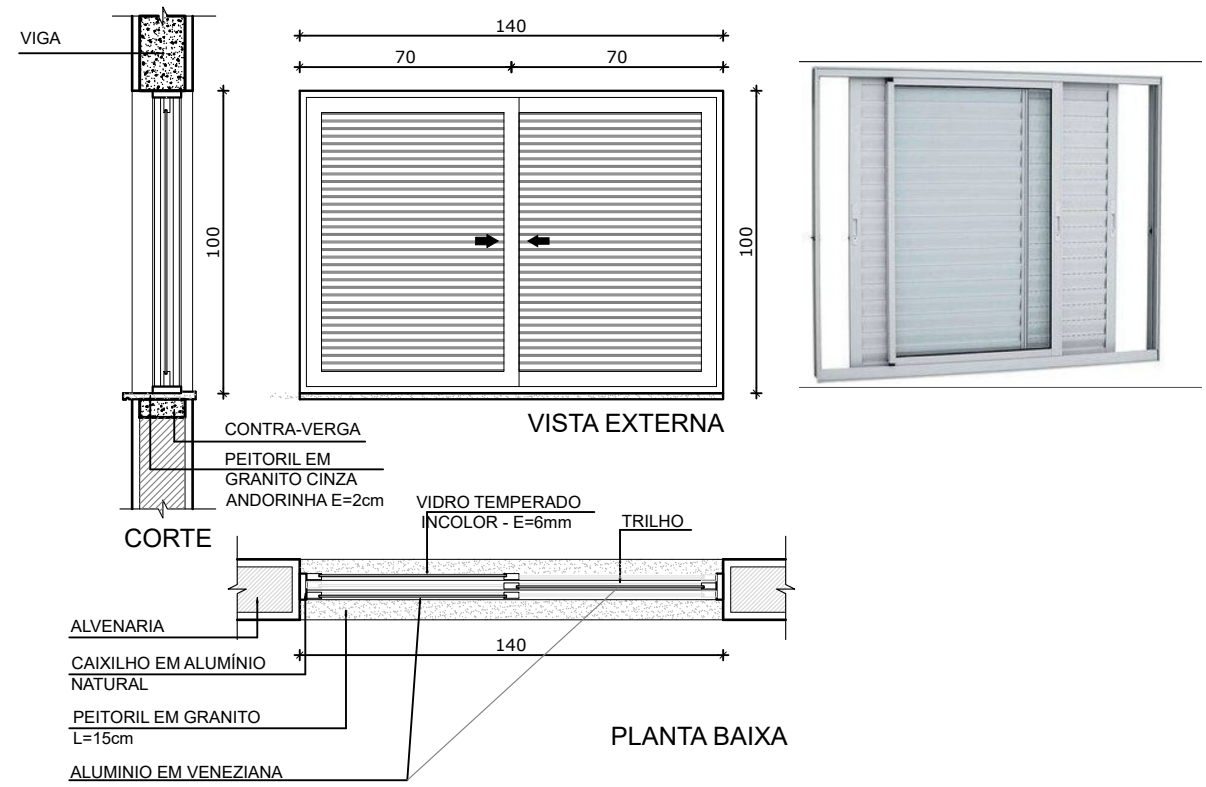

P1- PORTA DE MADEIRA COM VENEZIANA- 80x210

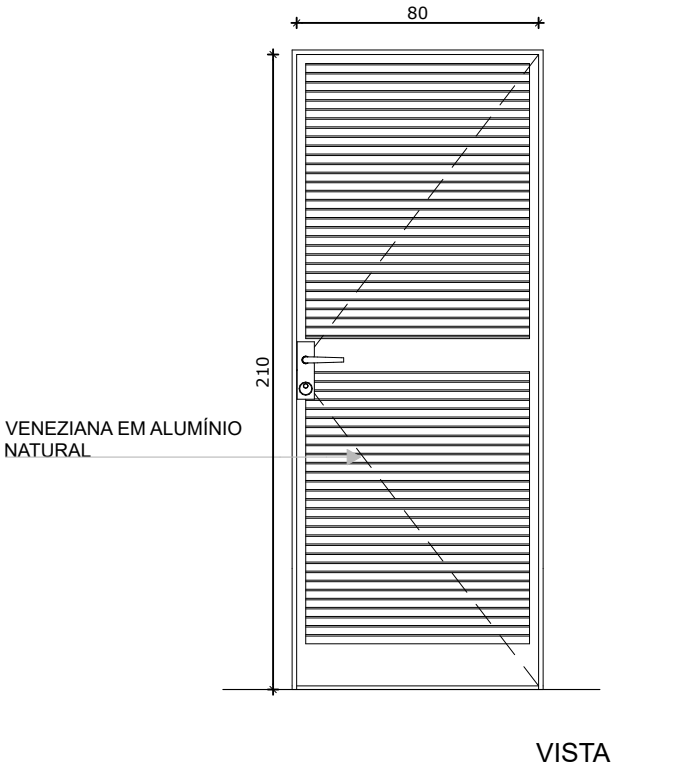

J4- JANELA DE CORRER- 120x100

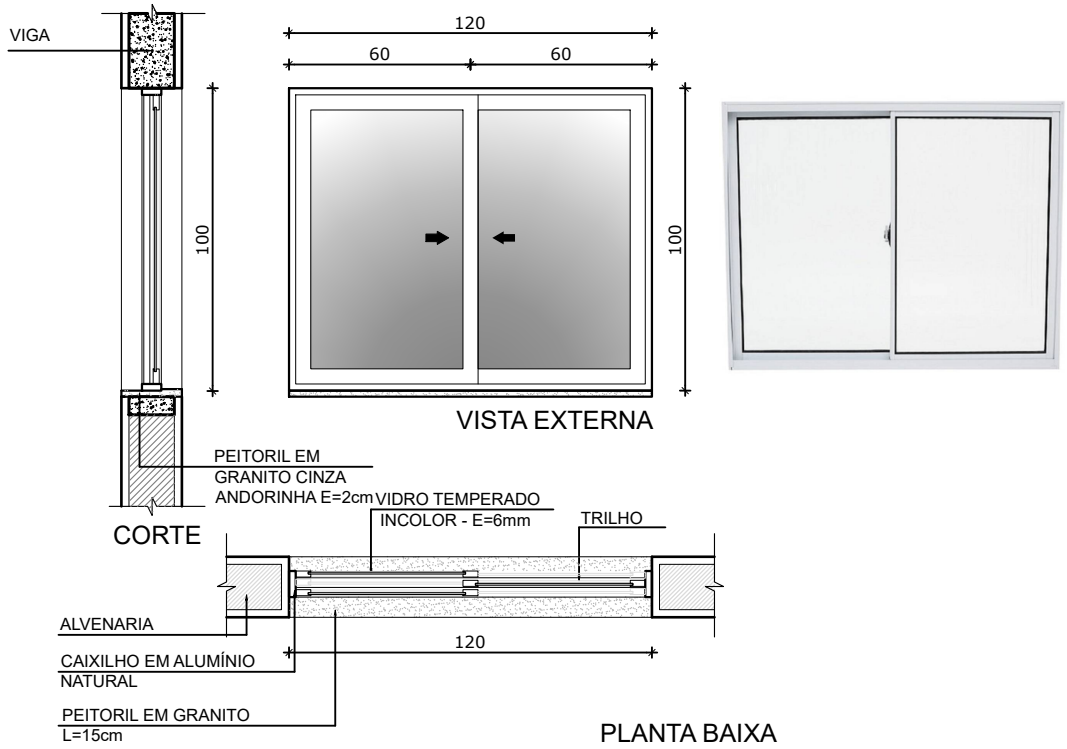

J3- JANELA DE CORRER- 140x100

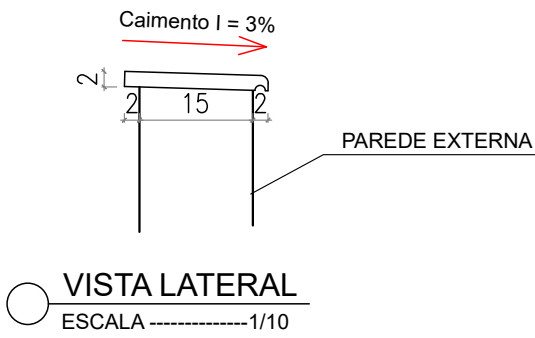
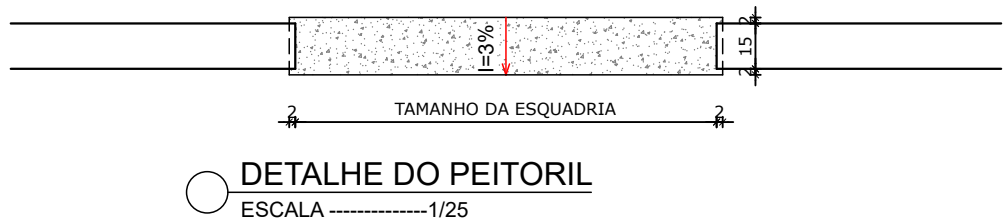
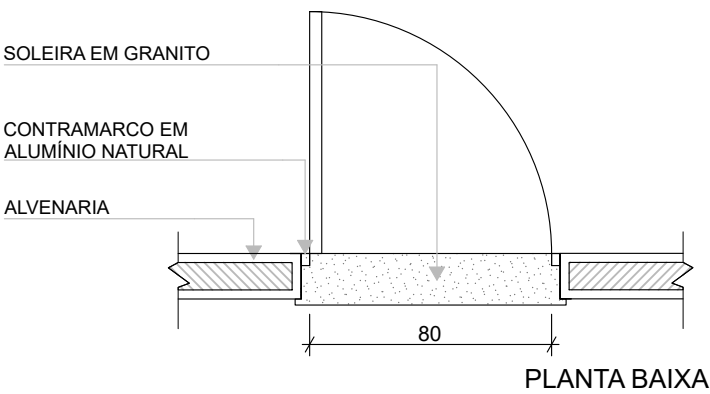
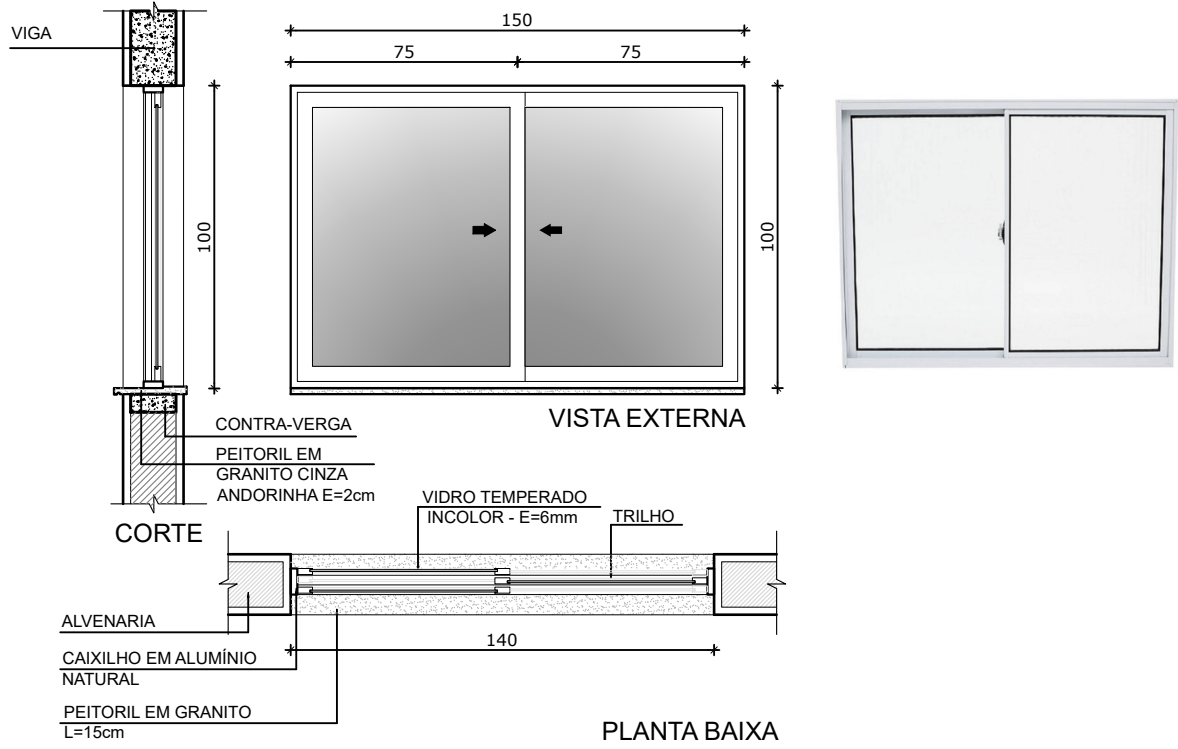

PLANEJAMENTO E ACESSORIA DE  
PROJETOS TÉCNICOS LTDA.

CLIENTE: PREFEITURA MUNICIPAL DE BAIXA GRANDE DO RIBEIRO - PI

PROJETO: CONSTRUÇÃO DE UNIDADES HABITACIONAIS NO MUNICIPIO DE  
BAIXA GRANDE DO RIBEIRO - PI

CONVÊNIO Nº: 970832- MINISTÉRIO DAS CIDADES/  
P. M. DE BAIXA GRANDE DO RIBEIRO (PI)

LOCALIDADE:  
ZONA URBANA

DESENHO:  
DETALHE DAS ESQUADRIAS

ESCALA:  
1/50

PROJETISTA:

Daniilo de Oliveira Soares  
Engenheiro Civil  
RN: 1915244544

DADOS DE CAMPO:  
TOPOGRAFO

DATA:  
2025

REV.:  
00

DESENHO/CAD:  
ANA VIANA

FORMATO:  
A2

PRANCHA Nº:  
ARQ.05/07